

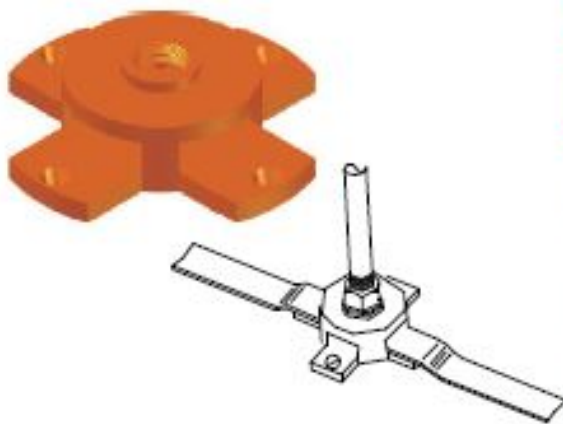

| ABRE Lightning Protection System - Flat Tape System



Air Terminal - Flat Air Rod Base

Part No.	Diameter	Material
ABC16	16mm	Copper
ABC20	20mm	Copper
ABA16	16mm	Aluminium
ABA20	20mm	Aluminium
ABC16T	16mm	Tinned Copper
ABC20T	20mm	Tinned Copper

This ABRE supportcopper, aluminum or tinned copper air terminal rod to connect and fixing with countersunk woodscrew 1 1/2" x no.10 and wall plug, used in connectionto meet IEC 62561-1

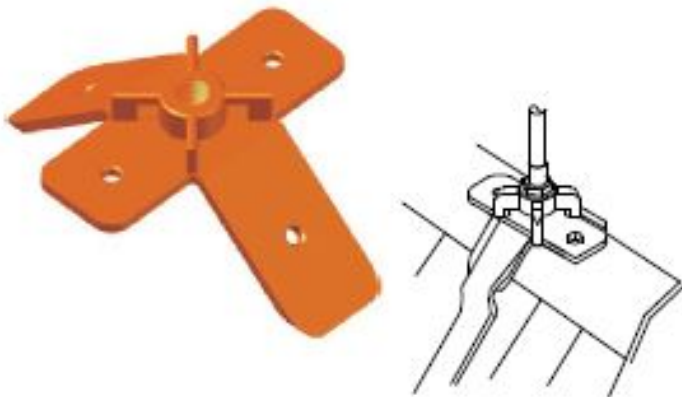

Air Terminal - Ridge Air Rod Base

Part No.	Diameter	Material
ARC16	16mm	Copper
ARC20	20mm	Copper
ARA16	16mm	Aluminium
ARA20	20mm	Aluminium
ARC16T	16mm	Tinned Copper
ARC20T	20mm	Tinned Copper

This ABRE support copper, aluminum or tinned copper air terminal rods on ridges to connect and fixing with countersunk woodscrew 1 1/2" x no.10 and wall plug, used in connection to meet IEC 62561-1.



